

COMPLAINT

SECONDARY COMPLAINTS

Grinding, clicking, jumps out of four-wheel-drive engagement

- Slotted case
- Worn bearing housing

CAUSE

Minimal OE engagement at roller and control groove allows roller to drop out of groove resulting in loss of four wheel drive. Soft case materials are subject to extreme wear. This wear is visible when the pump tab slots out the case.

CORRECTION

The longer pin and roller improve roller engagement with the control groove. Shims reduce bearing shaft end play and the new pump tab stop relocates the contact point.

Main Bearing Shim Kit

100567A-01K

4 Rear Output Bearing Shims
4 Input Bearing Shims

Shift Fork Guide Roller Repair Kit

100329-01K

1 Roller
1 Push-on Retainer
1 Roller Shaft

Pump Stop Tab Repair Kit

100912-01K

1 Pump Tab Stop
1 Spring Pin
2 Bolts
2 Washers

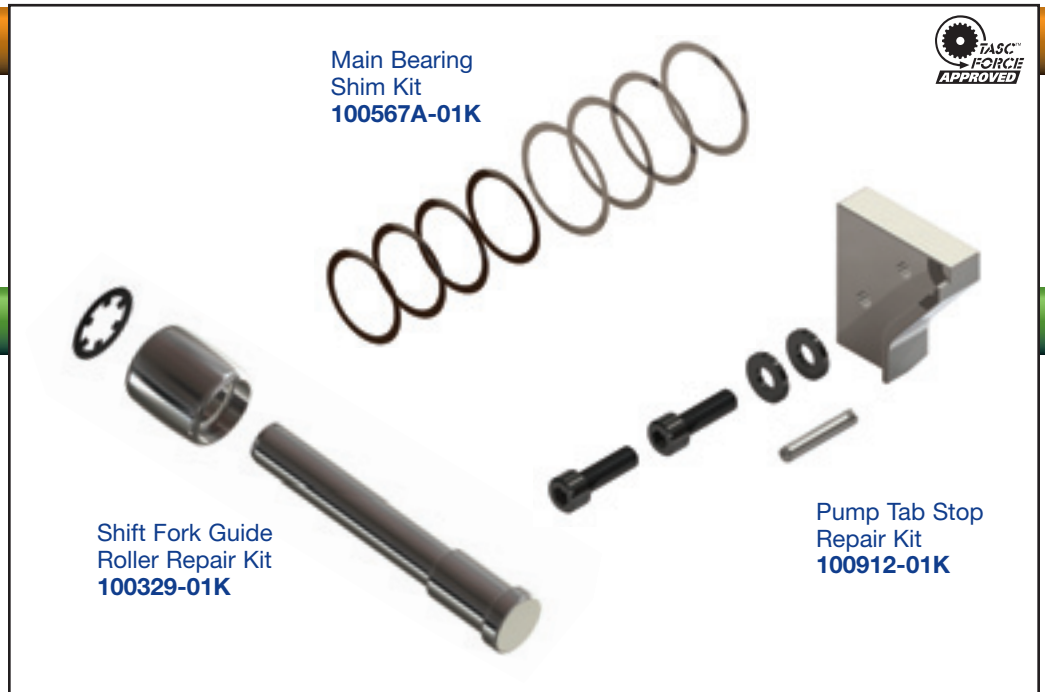

Sonnax Part Summary

Borg Warner 4405 and 4411 transfer cases often exhibit a variety of noise or engagement issues. The three kits offered, **100567A-01K**, **100329-01K** and **100912-01K** each address a problem found in many of these transfer cases.

Problems Include

- Unexpected loss of four-wheel-drive engagement.
- Erosion at the case material (slotting) where the pump tab contacts the case, allowing excessive motion at the pump tab.
- Excess axial play in the main bearing pockets.

Features & Benefits

- Shift fork guide roller & guide roller shaft improvements increase the depth of roller engagement.
- New pump tab stop relocates the contact point.
- Shims reduce bearing/shaft end play and reduce stress on all internal components.