

COMPLAINT

SECONDARY COMPLAINTS

Harsh downshifts, Flare on 1-2, 2-3, 5-6 upshift, B-1 band distress

- Firm 3-2, 2-1 and 6-5 coast downshifts
- Drive-ability changes with operating temperature

CAUSE

Wear at the B1 band control valve bore affects apply and release rate of the servo.

CORRECTION

The replacement Sonnax sleeve and valve corrects circuit pressure loss and restores control of band apply and release.

B1 Band Control Valve Kit

39741-22K

- 1 Valve
- 1 Sleeve
- 1 Spring



F-39741-TL22

- 1 Reamer
- 1 Guide Pin
- 1 Reamer Jig



Note: Fits Volvo (AM6); Opel (AF40); Peugeot (TF80); Saab (AF40/6); Land Rover (TF80); Ford (AF21) and Mazda (AW6A-EL).

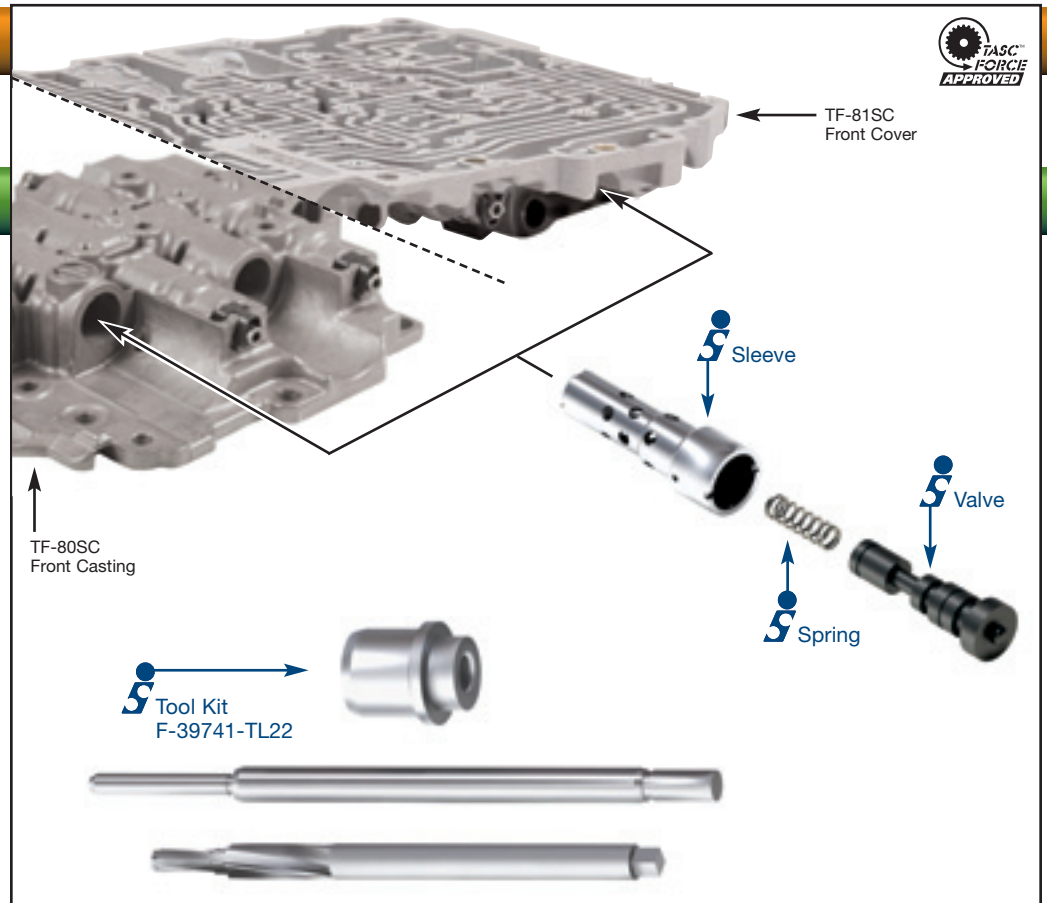

Features & Benefits

- Sonnax valve is hard-coat anodized aluminum to provide wear resistance.
- An annular groove has been added to the valve for better centering in the bore.
- The highly wear-resistant Sonnax sleeve provides over 80% more support than the OEM casting.
- A new spring is included to allow proper calibration.

You need this if...

Either a Wet Air Test or a Vacuum Test in the locations shown, result in leakage. A vacuum test must hold a minimum of 18".

