

COMPLAINT

SECONDARY COMPLAINTS

Premature clutch/band failure, poor reverse boost

• Poor soft shift quality • Insufficient line rise • Erratic buzz or uncontrollable pressure in reverse

CAUSE

A worn main regulator valve and worn reverse boost sleeve.

CORRECTION

These direct replacement main regulator valves prevent EPC oil from leaking to exhaust, while the replacement pressure regulator boost valve and sleeve kit restores the level of line rise required for reverse.

Pressure Regulator Valve & Boost Sleeve Kit

76948-01

1 Main PR Valve

Note: This valve is applicable only for the 4-spooled '91-'95 versions, not for the 3-spooled version.

76948-09

1 Main PR Valve

Note: This part replaces the 4-spool '96 & up valve identified in instructions.

76948-02K

1 PR Boost Valve
1 PR Boost Sleeve

Note: Works in all '91 & up applications.

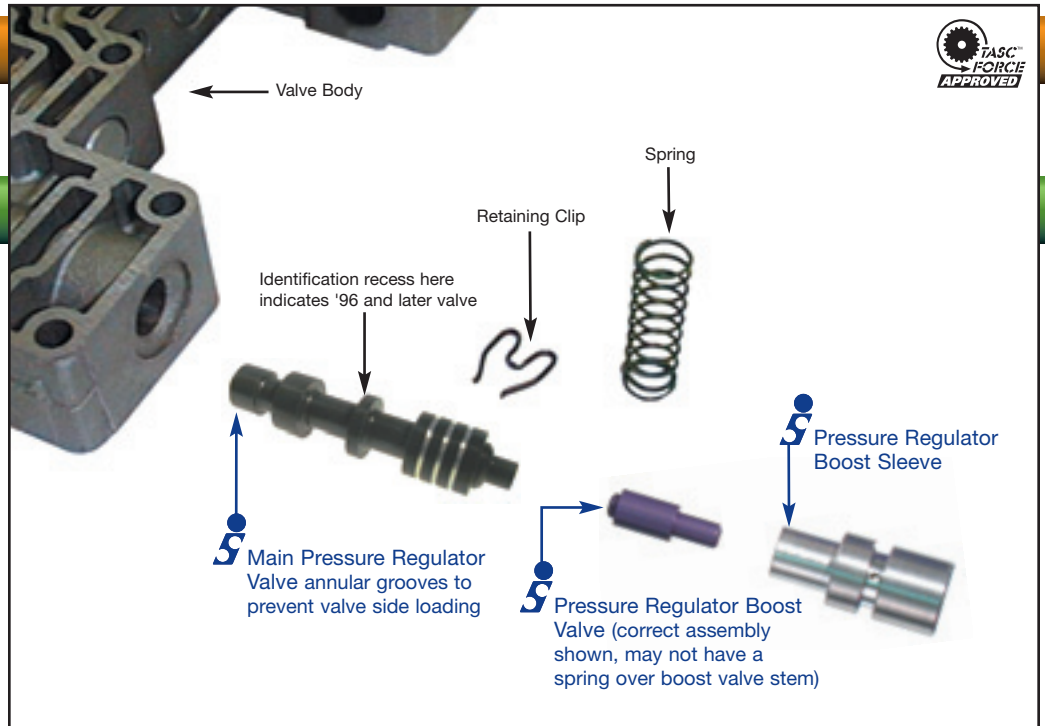

Sonnax Part Summary

A common complaint in vehicles with AODE/4R70W transmissions is low line pressure or throttle sensitive buzz, especially when hot. This is often caused by a worn main regulator valve. The valve frequently wears on the boost spool diameter and allows EPC (electronic pressure control) oil to leak to exhaust. This leakage results in poor line rise. When the oil temperature increases, the oil becomes less viscous and more leakage occurs. The two Sonnax replacement assemblies **76948-01** and **76948-09** eliminate the above problems with a direct replacement main regulator valve. Another common complaint with these transmissions is poor reverse boost, often the result of a worn pressure regulator boost sleeve. The sleeve should be checked while replacing the main pressure regulator valve. Sonnax offers a replacement pressure regulator boost valve and sleeve kit **76948-02K**.

Features & Benefits

- These closely toleranced parts are made from high-quality aluminum and have been specially hard-coated to eliminate excessive wear.
- Annular grooves have been added to the pressure regulator valve to allow an oil film to surround the valve, thus centering it in the bore to prevent side loading which causes premature wear.

Note: '91-'95 PR valve and '96 and later PR valve designs are not interchangeable.