

COMPLAINT

SECONDARY COMPLAINT

TCC apply and release problems, Code 628

- Reduced cooler and lube pressure

CAUSE

Severe wear of the bypass clutch control plunger valve sleeve.

CORRECTION

This tightly tolerated bypass clutch control sleeve and plunger valve are designed to prevent wear.

Bypass Clutch Control Sleeve & Plunger Valve

96201-06K

- 1 Bypass Sleeve
- 1 Bypass Plunger Valve

Also Available:

96206-01K AXODE, AX4S

96206-03K AX4N (.486" Large Spool)

96206-03K AX4N (.496" Large Spool)

Each kit contains the following

- 1 Bypass Clutch Control Sleeve
- 1 Bypass Clutch Control Plunger Valve

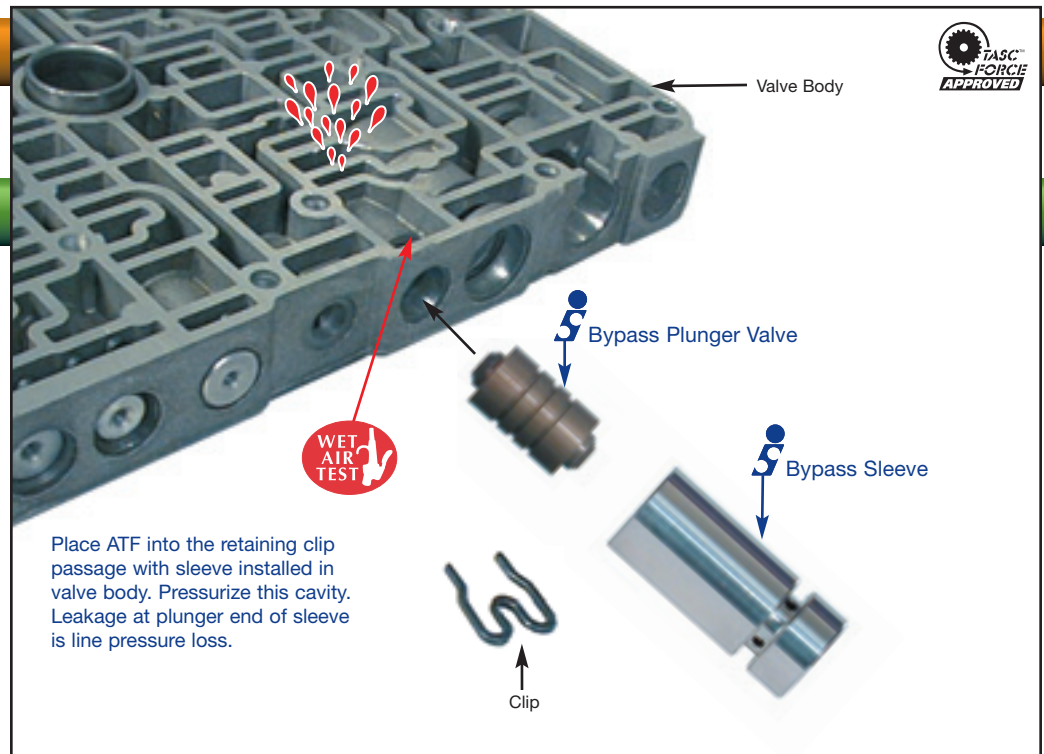

Sonnax Part Summary

Vehicles with an AXOD transmission may exhibit TCC apply and release problems and reduced cooler/lube flow. These complaints can be caused by severe wear of the bypass clutch control plunger valve sleeve. Line pressure entering the sleeve will be allowed to exhaust without properly stoking the converter bypass control valve. Sonnax has developed a tightly tolerated bypass clutch control sleeve and plunger valve **96201-06K** that restore hydraulic integrity and will eliminate these problems.

Features & Benefits

- The precision sleeve is manufactured from high-quality aluminum to prevent wear.
- Hard-coat anodized plunger valve resists wear.
- The spool length of the valve has also been lengthened to help prevent oil leakage.
- Annular grooves have been added to the valve to aid in centering it in the sleeve, which prevents wear related to side loading.

